

\$359,000 - Toni Avenue, Boutiliers Point

MLS® #201804477

\$359,000

Bedroom, Bathroom,
Land on 69.00 Acres

40-D, Boutiliers Point, NS

This large parcel (166.5 acres) located near the Head of St Margaret's Bay is an excellent investment opportunity. Adjacent to Island View Ridge subdivision area of \$300,000 to \$500,000 homes and only ten minutes to Upper Tantallon. Stunning ocean views of St Margaret's Bay from various points.

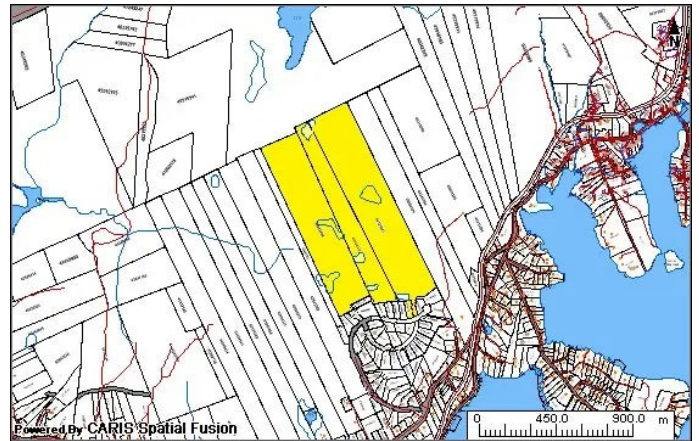

Essential Information

MLS® #	201804477
Price	\$359,000
Acres	69.00
Type	Land
Sub-Type	Unimproved Land
Status	Closed

Community Information

Address	Toni Avenue
Area	Halifax - Dartmouth
District	40-Timberlea, Prospect, St. Margaret's Bay
Sub-District	40-D
City	Boutiliers Point
County	Halifax
Province	NS
Postal Code	B3Z 1X5

Amenities

Utilities	Cable Connected, Electricity Connected, High Speed Internet, Phone Connected
-----------	--

Parking	Gravel
View	Ocean, Bay

Exterior

Lot Description	Partially Cleared, Rolling Slope, Sloping/Terraced, Wooded, Over 100 Acres
-----------------	--

Additional Information

Zoning	MU
--------	----

Listing Details

Listing Office	Enter Realty Limited
----------------	----------------------

NSAR IDX Reciprocity listings are displayed in accordance with NSAR's IDX Agreements and property information is provided under copyright© by the Nova Scotia Association of REALTORS®. The above information is from sources deemed reliable but it should not be relied upon without independent verification.

Listing information last updated on October 15th, 2025 at 6:17am ADT