

# \$67,500 - 4427 Highway 2, Wellington

MLS® #201905014

**\$67,500**

Bedroom, Bathroom,  
Land on 0.36 Acres

30-D, Wellington, NS

Your opportunity to own a prime piece of property in Wellington right on Highway #2. With R6 zoning you have the option of owning a single-family home or operating any number of commercial opportunities such as a double duplex dwelling, one or more apartment dwellings, a boarding, rooming and or lodging house.

## Essential Information

MLS® #	201905014
Price	\$67,500
Acres	0.36
Type	Land
Sub-Type	Unimproved Land
Status	Closed

## Community Information

Address	4427 Highway 2
Area	Halifax - Dartmouth
District	30-Waverley, Fall River, Oakfield
Sub-District	30-D
City	Wellington
County	Halifax
Province	NS
Postal Code	B3L 2C2

## Amenities

Utilities	Cable Connected, Electricity Connected, High Speed Internet, Phone
-----------	--

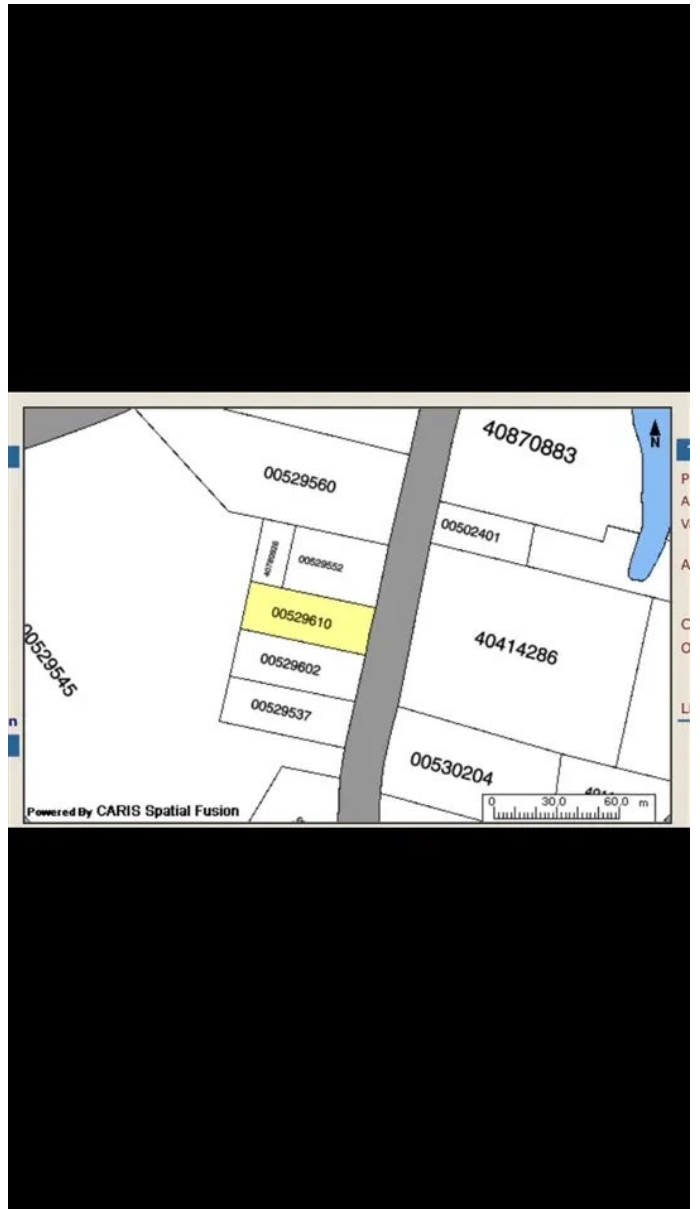

Connected

Parking

None

## Exterior

Lot Description

Cleared, Under 0.5 Acres

## Additional Information

Zoning

R6

## Listing Details

Listing Office

Royal LePage Atlantic

NSAR IDX Reciprocity listings are displayed in accordance with NSAR's IDX Agreements and property information is provided under copyright© by the Nova Scotia Association of REALTORS®. The above information is from sources deemed reliable but it should not be relied upon without independent verification.

Listing information last updated on October 15th, 2025 at 3:17pm ADT