

MLS® #202409708

Bedroom, Bathroom,
Land on 9.99 Acres

The area between East River and Bayswater is growing in popularity. Located about 15 min from Highway 103 (Exit 7). With all the amenities of Chester nearby, a short distance to great beaches, and a reasonable commute to Halifax, this may be the ideal spot to build your new home. This property has approximately 10 acres, with a driveway access and culvert already in place. The land is mostly mature hardwood and softwood, a very pretty setting.

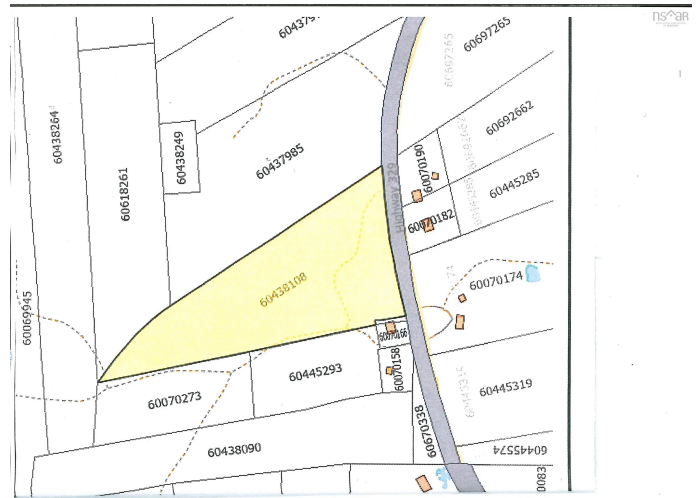

MLS® #	202409708
Price	\$69,900
Acres	9.99
Type	Land
Sub-Type	Unimproved Land
Status	Closed
Date Sold	September 23rd, 2024

Address	Lot 1 Highway 329
Area	South Shore
District	405-Lunenburg County
Sub-District	A2
City	Bayswater
County	Lunenburg
Province	NS

Postal Code B0J 1T0

Amenities

Utilities Cable Connected, Electricity Connected, Phone Connected

Parking Dirt

Exterior

Lot Description Wooded, 10 to 49.99 Acres

Additional Information

Zoning GB - General Basic

Listing Details

Listing Office Royal LePage Atlantic

NSAR IDX Reciprocity listings are displayed in accordance with NSAR's IDX Agreements and property information is provided under copyright© by the Nova Scotia Association of REALTORS®. The above information is from sources deemed reliable but it should not be relied upon without independent verification.

Listing information last updated on October 12th, 2025 at 2:17am ADT